

INSTALLATION OF ROOF CONSOLE

80 Series Landcruiser GXL 01/95 – 03/98

PART NO. RC80GXL95

Failure to connect coloured wiring correctly and tape up all connections as described in following instructions will result in an electrical short and void console warranty.

For this installation you will need a **hand held** Phillips screwdriver, wire cutter, wire crimper, 10mm ring spanner, insulation tape and Loctite. **Loctite all console screws when installing.**

DIESEL MODELS ONLY: Refer to Sub Tank conversion attached first before installing console.

****PETROL MODELS:*** Please note that attached Sub Tank conversion applies to **DIESEL MODELS ONLY** and will not work in Petrol Models. An auto electrician needs to perform sub tank wiring to main fuel gauge.

VEHICLE PREPARATION:

Swing Sun Visors around to side and lay flat to roof for ease of installation.

Remove roof binnacle with gauges by removing light cover (one screw) to expose the two brass coloured rear screws. Undo these, then undo the two exposed front screws, unplug all wiring and tuck back out of the way. Remove rear view mirror, retain screws. **Loosely** bolt the Cover Plate supplied into the four (4) 6mm binnacle bolt holes using four (4) of the 6mm x 16mm **black** Phillips round head bolts supplied. Now tighten two **rear** Cover Plate bolts and remove **front** two bolts.

Switch interior light to 'off' position, remove from roof and disconnect wiring. Put light and screws with roof binnacle in a safe place for refit upon removal of console.

Rear Mount Plate Installation: Using a **hand held** Phillips screw driver fasten Rear Mount Plate to four interior light screw holes. Use four 10# x 12mm Phillips self tapping screws provided and fasten plate through **marked holes** ensuring captive nuts point down and face **rear** of vehicle and interior light plug protrudes out one side of plate. Fasten **yellow** earth wire supplied to one of these screws.

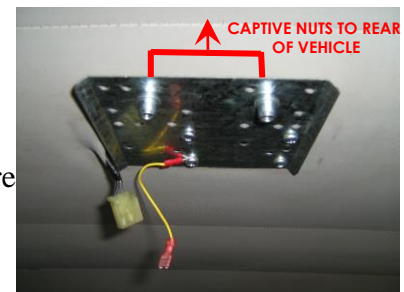

INSTALLATION PREPARATION:

Connect wiring extension supplied to console wiring loom; connect **red** to **red**, **white** to **white** and **yellow** to **yellow**. Tape up connections.

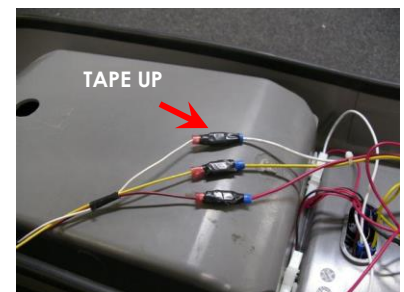

Fasten Front Mount Bracket supplied to **inside** front of Roof Console using two (2) 6mm x 16mm **black** Phillips round head bolts supplied.



Use 'Blu-Tack' in fit kit to adhere one of the 6mm x 20mm round head bolts to **hand held** Phillips screwdriver, put a small amount of 'Loc-Tite' on thread and store in convenient location, eg: on seat of vehicle or in/on centre console.

Comfortable work position: Slide seats all way back, if right handed, sit in passenger seat; if left handed, sit in driver seat.

CONSOLE INSTALLATION:

Stand console upright on front seat and plug console wiring into interior light plug of vehicle. Plug **white** wire on console into **pink/blue** wire of interior light plug, **red** into **blue/yellow** wire and **yellow** into **yellow** earth wire fastened to Rear Mount Plate. Check that console lights work independently once doors are shut and timer switches off then tape up to ensure wires do not become disconnected.



Note: An **on/off** switch is located above radio opening; when **off** it acts as a kill switch--no lights will work; when **on** lights work independently as map/interior lights once doors are shut and timer switches off. When doors are open lights work as door/interior lights.

Position console in centre of vehicle then look up under and into rear mounting hole; line up captive nuts in Rear Mount Plate with slotted fastening holes, tuck wiring loom out of way so as not jam between console body and rear mount plate. Use the 6mm x 20mm round head Phillips bolt 'Blu Tacked' to your Phillips screw driver and **loosely** fasten rear of console up to one of captive nuts in Rear Mount Plate.

Line Front Mount Bracket holes up with rear view mirror screw holes and push front of console **firmly** up against roof. Fasten through outer holes using two (2) 6mm x 16mm **black** Phillips round head screws then screw rear view mirror back into place through Front Mount Bracket using original screws.

'Blu Tack' other 6mm x 20mm round head Phillips bolt to screwdriver, apply 'Loc-Tite' and fasten into remaining captive nut in Rear Mount Plate. Tighten both rear bolts. **Note:** *Only tighten bolts up firm so as console is held to roof, **do not** keep on tightening so as to bend rear mount plate downward; do rear bolts up with equal tension.*

Open Locker Box and remove Microphone Cable Holder and Rear Mounting Hole Cover from inside; fasten Hole Cover in place using screws supplied. Fasten Microphone Cable Holder in place as per radio installation instructions.

Fit Kit: RC80GXL95

- One (1) Cover Plate
- One (1) Front Mount Bracket
- One (1) Rear Mount Plate (colour marked)
- One (1) Wiring extension
- One (1) Yellow earth wire
- Four (4) 10# x 12mm Phillips self tappers
- Six (6) 6mm x 16mm **black** Phillips round head bolts
- Two (2) 6mm x 20mm Phillips round head bolts
- One (1) Small piece of 'Blu Tack'
- Three (3) x 100mm Sticky back foam pieces

Sub Tank Conversion Kit: *Diesel Models Only

- One (1) 12V relay switch & wiring
- One (1) 6mm Nyloc nut
- One (1) 6mm washer

RADIO INSTALLATION

Radio Insert Installation: for smaller size radios

PLEASE NOTE: Radio Inserts NOT INCLUDED.

Decorative side of insert faces outwards and snaps out over bottom of tray surround.

To install insert, squeeze top and bottom together; push/bend sides and squeeze into tray surround from inside to outside until bottom lip on decorative side of insert snaps/pops out over bottom of tray surround, prize with fingers to ensure bottom lip of insert is in place over tray surround as described. **Do not** scratch or mark insert or surround by prising/levering with tools; use hands/fingers only.



Radio Installation:

Place protective cover on work bench to avoid scratching console. Place console on protective cover and using a sharp knife cut a 30mm x 100mm section out of storage tray 25mm in from where rear of radio will be when installed. Use a small amount of methylated spirits on a clean cloth to clean exposed part of console and bottom rear of radio.

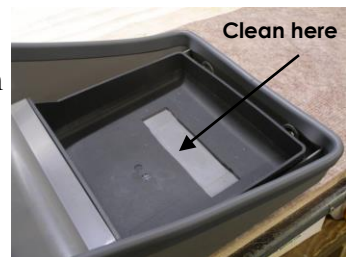

Peel one side of protective backing from foam strip supplied; apply pressure with palm of hand to adhere foam to exposed part of console. Peel backing off other side of foam strip and add one or more strips of foam to suit different size radios (see chart below). This will keep radio level with bottom of surround.



Insert radio on an angle until radio protrudes 15mm out over bottom of tray surround or insert and straighten; lay flat onto sticky back foam and apply firm pressure to top of radio with palm of hand for 30 seconds to ensure good adhesion.



Sticky back foam chart:

- One (1) strip- standard size radios
- Two (2) strips- Icom and Uniden
- Three (3) strips- GME Electrophone

Microphone and Microphone Cable Holder installation:

Install in a position that suits best, depending on vehicle and Radio model. Ensure microphone or microphone cable and holder does not foul on sun visor when pulled down.



Microphone clip on slight angle



Left hand cable outlet radios



Microphone clip on acute angle

Sub Tank to Main Tank Gauge Wiring Conversion

1/95 - 3/98 Diesel 80 Series GXL Landcruiser

This conversion allows removal of the subtank and altimeter binnacle in the roof. The subtank will then read from the main gauge when the sub tank button is activated

Step 1: Remove left hand kick panel by undoing large plastic holding screw located in the firewall, pull up plastic door sill cover from the rear so as to release clips.

Step 2: Locate the three plugs 'A', 'B' and 'C' illustrated. These are located in the forward loom which travels beneath the plastic door sill cover removed in Step 1. Remove part of insulation off loom so as to expose wiring.

Step 3: Looking from beneath plug 'A' locate red wire fourth from left in top row and cut wire 4cm down from plug, strip ends and connect red wires from plug and loom into red wires from relay.

STEP 3: PLUG A (Small oblong plug)

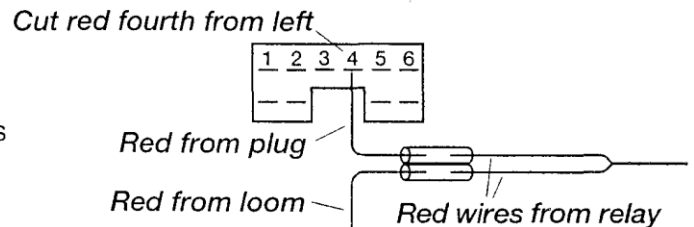

Step 4: Looking from beneath plug 'B' locate yellow/blue wire fourth from left in top row and cut wire 4cm down from plug, strip end from loom, leave end from plug as is. Connect yellow/blue wire from loom only into brown from relay.

STEP 4: PLUG B (Large square plug)

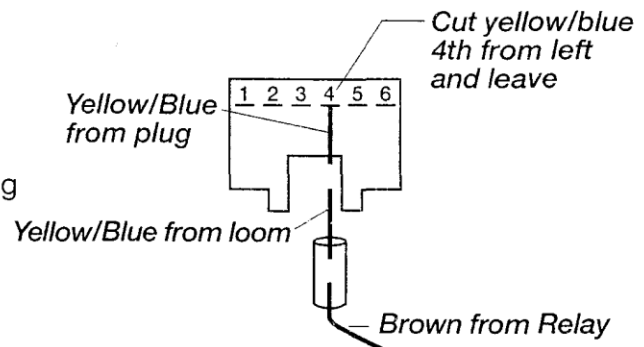

Step 5: Looking from beneath plug 'C' locate yellow/red wire fifth from left in top row and cut wire 4cm down from plug. Connect yellow wire from relay to yellow/red wire from plug. Connect green wire from relay to yellow/red wire from loom.

STEP 5: PLUG C (Large oblong plug)

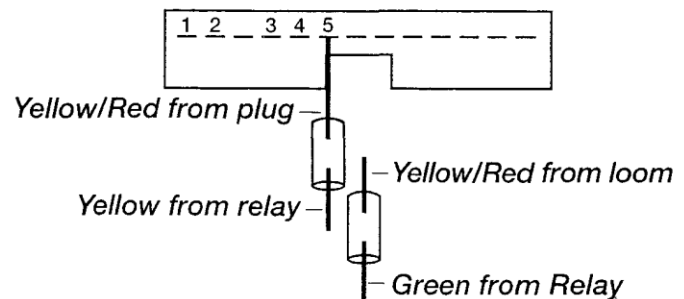

Step 6: Fasten white earth wire and relay switch to the lower threaded bolt in side wall of vehicle using 6mm nyloc nut and washer supplied.

NB: We do recommend an auto electrician carry out this conversion.