

INSTALLATION OF ROOF CONSOLE

NISSAN NAVARA D40 DUAL CAB 11/05 – 03/15

PART NO. RCNAV06

Failure to connect coloured wiring correctly and tape up all connections as described in following instructions may result in an electrical short and void console warranty.

For this installation you will need a **short** & a **long hand held** Phillips screw driver, electrical tape, sharp craft knife, small electric drill, a 'stubby' 3.5mm drill bit and Loctite. **Use Loctite on all console screws when installing.** All hardware and screws supplied in fit kit.

Vehicle preparation:

Swing sun visors around to side and lay flat for ease of installation. Remove interior light pod/assembly from roof of vehicle; to do this use hands to unclip pod from housing by pulling down from rear. Unplug wiring and put pod aside with the two plastic snap cap covers provided for refitting to vehicle upon removal of console.

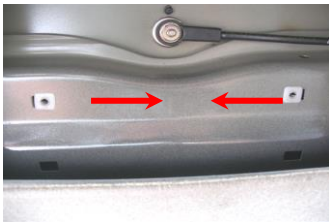

Front Mount Bracket installation: (image 1)

Insert square plastic screw grommets supplied into oblong holes in roof where interior light pod was and slide inwards.

Using a **hand held** Phillips screw driver fasten Front Mount Bracket to the two plastic plugs using two 10# x 20mm Phillips self tapping screws supplied.

Rear Mount Plate installation:

Remove rear interior light. Screw drilling template to vacant interior light screw holes using original screws. Two parallel holes in template are to **front** of vehicle.

Note: do not drill holes in drill template out any larger to accommodate original screws.

Insert a 'stubby' 3.5mm drill bit into an electric drill ensuring **only 20mm of drill bit protrudes out of drill chuck**. Drill up through one of front holes in drill template and fasten using 8# x 20mm Phillips self tapping screw supplied. Now drill up through remaining hole. **Note: You are only drilling into inner skin of roof rib not the roof itself.** Undo 8# x 20mm screw, remove Drill Template and discard. Return interior light to original position.

There are two plastic snap cap covers provided to cover drilled holes upon removal of console, put aside with light pod.

Using a **hand held** Phillips screw driver fasten Rear Mount Plate through the two marked holes in plate into the two drilled holes using two 12# x 20mm Phillips self tapping screws supplied; ensure captive nuts are to **front** of vehicle and point **down**.

RX and SE Models:

Front Mount Bracket:

Remove front light assembly. Tuck wiring harness away into roof cavity. Using sharp Craft Knife, cut roof lining for front mount bracket same width as is, and an additional **110mm forward**. Four (4) rectangular holes will be exposed in roof rib; insert plastic plugs into **rear most** holes and slide inwards (as per image 1). Fasten Front Mount Bracket to plugs using two 10# x 20mm Phillips screws supplied.

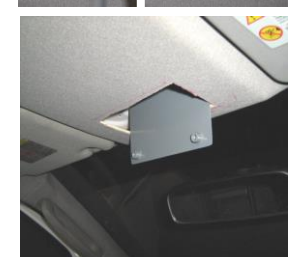

Comfortable work position:

Slide seats all way back, if right handed, sit in passenger seat; if left handed, sit in driver's seat.

Installation preparation:

Connect wiring extension supplied to console wiring loom; connect **red** to **red**, **white** to **white** and **yellow** to **yellow**. Tape up connections **individually**.

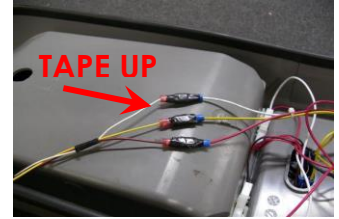

Stand console upright on front seat and plug console wiring extension into interior light wiring of vehicle; plug **white** wire from console into **yellow** wire of interior light plug, **yellow** into **black** wire and **red** into **red** wire. Check that console lights work independently once doors are shut and timer switches off, then **tape up to ensure wires do not become disconnected**.



There is an 'on/off' switch located above radio opening. When 'off' it acts as a kill switch-- no lights will work. When 'on' lights will work independently as map/interior lights when doors are shut and timer switches off. When doors are opened lights will work as door/interior lights.

Use 'Blu-Tack' in fit kit to adhere one of the 6mm x 30mm round head bolts to **hand held** Phillips screwdriver, put a small amount of 'Loctite' on thread and store in convenient location, eg: on seat of vehicle or in/on centre console.

Console installation:

Hold console up in position **over Front Mount Bracket** ensuring mount bracket slides/fits in between front of console and rear of radio surround/storage tray. Push Console firmly up against roof lining and using a **short** Phillips screwdriver, fasten Console to captive nuts in Front Mount Bracket using the two 6mm x 16mm **black** round Phillips bolts supplied.

Look up under and into rear mounting hole; line up captive nuts in Rear Mount Plate with slotted fastening holes, tuck wiring out of way so as not to jam between console body and rear mount plate. Use the 6mm x 30mm round head Phillips bolt 'Blu-Tacked' to your **hand held** Phillips screwdriver and **loosely** fasten rear of console up to one of captive nuts in Rear Mount Plate.

Blu-Tack other 6mm x 25mm round Phillips head bolt to screwdriver, apply 'Loc-Tite'; fasten into Rear Mount Plate and tighten rear bolts. **NOTE:** *Only tighten rear bolts up firm so console is held to roof. **DO NOT** keep tightening so as to bend rear mount plate downwards. Do rear bolts up with equal tension.*

Fit Kit: To suit both Dual and King Cab

- One (1) Front Mount Bracket
- One (1) Rear Mount Plate
- One (1) Drill Template
- One (1) 8# x 20mm Phillips head self tapping screw
- One (1) Console Wiring Extension
- One (1) Yellow Earth wire
- One (1) Small piece of 'Blu-Tack'
- Two (2) Square plastic screw grommets
- Two (2) 10# x 20mm Phillips self tapping screws
- Two (2) 12# x 20mm Phillips self tapping screws
- Two (2) 6mm x 30mm Phillips round head bolts
- Two (2) 6mm x 16mm **Black** Phillips round head bolts
- Two (2) Grey Plastic Snap Caps
- Two (2) Plastic Snap Cap Washers
- Three (3) Pieces of sticky back foam

INSTALLATION OF ROOF CONSOLE

NISSAN NAVARA D40 *KING CAB 11/05 – 03/15

PART NO. RCNAV06

Failure to connect coloured wiring correctly and tape up all connections as described in following instructions may result in an electrical short and void console warranty.

For this installation you will need a **short** & a **long hand held** Phillips screwdriver, electrical tape, small electric drill, a 'stubby' 3.5mm drill bit and Loctite. **RX Models only:** sharp 'Stanley' knife or similar, tape measure & steel ruler. **Use Loctite on all console screws when installing.** All hardware and screws supplied in fit kit.

Vehicle preparation:

Swing sun visors around to side and lay flat for ease of installation.

ST-X Model: Remove front interior light pod from roof of vehicle; to do this use hands to unclip pod from housing by pulling down from rear. Unplug wiring and put pod aside with the two plastic snap cap covers provided for refitting to vehicle upon console removal.

Rear Mount Plate installation:

Remove rear interior light. Place marked hole (king cab) of rear mount plate over rearmost screw hole and mark opposing hole (on other side). Drill out using 3.5mm drill bit ensuring **only 20mm of drill bit protrudes out of drill chuck.**

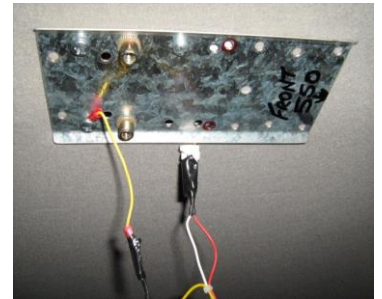

Using a **hand held** Phillips screw driver fasten Rear Mount Plate through two marked holes in plate using two 12# x 20mm Phillips self tapping screws supplied*; ensure captive nuts are to **front** of vehicle and point **down**.

Note: **Fasten yellow earth wire supplied under one screw (*models with 2 wires to interior light plug only).**

ST-X Model:

Front Mount Bracket:

Insert square plastic screw grommets supplied into oblong holes in roof where light pod was and slide inwards.



Using a **hand held** Phillips screwdriver fasten Front Mount Bracket to plastic plugs using two 10# x 20mm Phillips screws supplied.



RX Model:

Front Mount Bracket:

Measure from **front edge** of Rear Mount Plate 550mm towards **front of vehicle**. Find centreline of hood lining at this point and measure 82.5mm in both left and right direction then mark a 165mm line. From this line measure back towards rear of vehicle 50mm, mark out a rectangle 165mm wide and 50mm long then cut out section of roof lining using sharp Stanley knife. Four (4) rectangular holes will be exposed in roof rib; insert plastic plugs into **rear most** holes and slide inwards (as per above). Fasten Front Mount Bracket to plugs using two 10# x 20mm Phillips screws supplied.



Comfortable work position:

Slide seats all way back, if right handed, sit in passenger seat; if left handed, sit in driver's seat.

Installation preparation:

Connect wiring extension supplied to console wiring loom; connect **red** to **red**, **white** to **white** and **yellow** to **yellow**. Tape up connections **individually**.

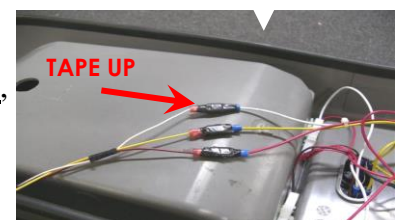

Stand console upright on front seat and plug console wiring extension into interior light wiring of vehicle;

ST-X Model: Plug **white** wire from console into **yellow** wire of interior light plug, **red** into **red** wire and **yellow** into **black** wire.

RX Model: Plug **white** wire from console into **pink** wire of interior light plug, **Red** into **yellow** plug wire and **yellow** into **yellow** earth wire.



Check that console lights work independently once doors are shut and timer switches off, then tape up to ensure wires do not become disconnected.

There is an 'on/off' switch located above radio opening. When 'off' it acts as a kill switch-- no lights will work. When 'on' lights will work independently as map/interior lights when doors are shut and timer switches off. When doors are opened lights will work as door/interior lights.

Use 'Blu-Tack' in fit kit to adhere one of the 6mm x 30mm round head bolts to **hand held** Phillips screwdriver, put a small amount of 'Loctite' on thread and store in convenient location, eg: on seat of vehicle or in/on centre console.

Console installation:

Hold console up in position **over Front Mount Bracket** ensuring mount bracket slides/fits in between front of console and rear of radio surround/storage tray. Push Console firmly up against roof lining and using a **short** Phillips screwdriver fasten Console to captive nuts in Front Mount Bracket using the two 6mm x 16mm **black** round Phillips bolts supplied.

Look up under and into rear mounting hole; line up captive nuts in Rear Mount Plate with slotted fastening holes, tuck wiring out of way so as not to jam between console body and rear mount plate. Use the 6mm x 30mm round head Phillips bolt 'Blu-Tacked' to your **hand-held** Phillips screwdriver and **loosely** fasten rear of console up to one of captive nuts in Rear Mount Plate.

Blu-Tack other 6mm x 25mm round Phillips head bolt to screwdriver, apply 'Loctite'; fasten into Rear Mount Plate and tighten rear bolts. **NOTE:** *Only tighten rear bolts up firm so console is held to roof.*

DO NOT keep tightening so as to bend rear mount plate downwards. Do rear bolts up with equal tension.

RADIO INSTALLATION

Radio Insert Installation: for smaller size radios

PLEASE NOTE: Radio Inserts NOT INCLUDED.

Decorative side of insert faces outwards and snaps out over bottom of tray surround.

To install insert, squeeze top and bottom together; push/bend sides and squeeze into tray surround from inside to outside until bottom lip on decorative side of insert snaps/pops out over bottom of tray surround, prize with fingers to ensure bottom lip of insert is in place over tray surround as described. **Do not** scratch or mark insert or surround by prising/levering with tools; use hands/fingers only.



Radio Installation:

Place protective cover on work bench to avoid scratching console. Place console on protective cover and using a sharp knife cut a 30mm x 100mm section out of storage tray 25mm in from where rear of radio will be when installed. Use a small amount of methylated spirits on a clean cloth to clean exposed part of console and bottom rear of radio.



Peel one side of protective backing from foam strip supplied; apply pressure with palm of hand to adhere foam to exposed part of console. Peel backing off other side of foam strip and add one or more strips of foam to suit different size radios (see chart below). This will keep radio level with bottom of surround.

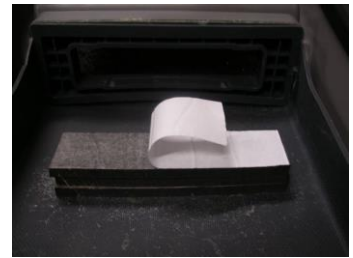

Insert radio on an angle until radio protrudes 15mm out over bottom of tray surround or insert and straighten; lay flat onto sticky back foam and apply firm pressure to top of radio with palm of hand for 30 seconds to ensure good adhesion.



Sticky back foam chart:

- One (1) strip- standard size radios
- Two (2) strips- Icom and Uniden
- Three (3) strips- GME Electrophone

Microphone and Microphone Cable Holder installation:

Install in a position that suits best, depending on vehicle and Radio model. Ensure microphone or microphone cable and holder does not foul on sun visor when pulled down.



Microphone clip on slight angle



Left hand cable outlet radios



Microphone clip on acute angle