

INSTALLATION OF ROOF CONSOLE

PRADO 90 series 7/96 – 8/02

Part No. RCPR96

Failure to connect coloured wiring correctly and tape up all connections as described in following instructions may result in an electrical short and void console warranty.

For this installation you will need a **hand held** Phillips screwdriver, steel ruler, insulation tape and Loctite. **Use Loctite on all console screws when installing.**

VEHICLE PREPARATION:

Swing Sun Visors around to side and lay flat to roof for ease of installation.

Switch interior light to 'off' position, remove from roof, disconnect wiring and put aside, retain screws for fitting.

Remove the rear-view mirror; use steel ruler to lever plastic cover off sideways and undo the two screws beneath.

Remove the map lights; slide steel ruler (lever tool) in from the front, between light housing and roof lining; at a position 60mm in from each end and lever downwards to remove cover and repeat to remove light housing. No damage can be caused as the lights are simply held in with spring loaded clips. Unplug wires, tuck wires and plug back into void in roof. Put lights aside for reinstallation upon removal of console.



Rear Mount Plate Installation: Using a **hand held** Phillips screwdriver fasten Rear Mount Plate to the two vacant interior light screw holes. Use original interior light screws and fasten plate through **marked holes** ensuring captive nuts are to **front** of vehicle and interior light plug protrudes out the side of plate. Fasten **yellow** earth wire supplied to one of these screws.

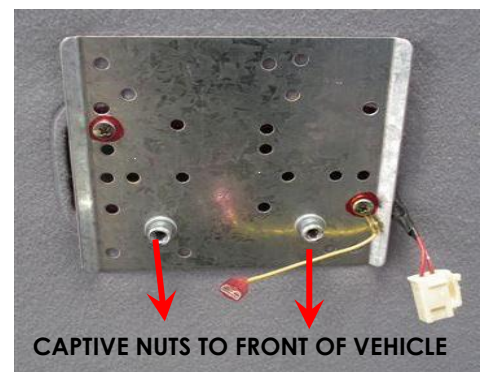

Front Mount Bracket Installation: Fasten Front Mounting Bracket supplied to **inside** front of Roof Console using two (2) 6mm x 16mm **black** Phillips round head bolts supplied.



Installation preparation: Connect wiring extension supplied to console wiring loom; connect **red** to **red**, **white** to **white** and **yellow** to **yellow**. Tape up all connections.

Comfortable work position: Slide seats all way back, if right handed sit in passenger seat; if left handed, sit in driver seat.

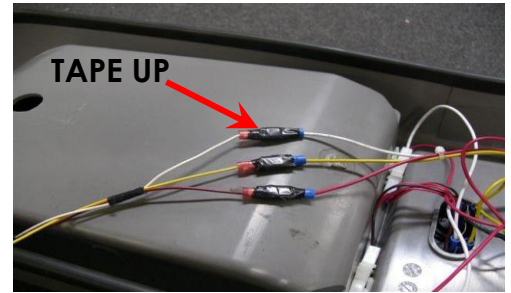

Use 'Blu-Tack' in fit kit to adhere one of the 6mm x 25mm round head bolts to Phillips head screw driver and store in convenient location, eg: on seat of vehicle or in/on centre console.

CONSOLE INSTALLATION:

Stand console upright on front seat and plug console wiring into interior light plug of vehicle. Plug **white** wire on console into **red/grey** wire of interior light plug, **red** into **red** wire and **yellow** into **yellow** earth wire fastened to Rear Mount Plate. Check that console lights work independently once doors are shut and timer switches off then tape up to ensure wires do not become disconnected.



There is an 'on/off' switch located above radio opening. When 'off' it acts as a kill switch-- no lights will work. When 'on' lights work independently as map/interior lights when doors are shut and timer switches off; when doors are opened lights will work as door/interior lights.

Position console in centre of vehicle then look up under and into rear mounting hole; line up captive nuts in Rear Mount Plate with slotted fastening holes, tuck wiring loom out of way so as not jam between console body and rear mount plate. Use the 6mm x 25mm round head Phillips bolt 'Blu Tacked' to your Phillips screw driver and **loosely** fasten rear of console up to one of captive nuts in Rear Mount Plate.

Line Front Mount Bracket holes up with rear view mirror screw holes and push front of console **firmly** up against roof. Screw rear view mirror back into place through Front Mount Bracket using original screws and return plastic cover.

'Blu-Tack' other 6mm x 25mm bolt to screw driver, fasten into Rear Mount Plate and tighten rear bolts.

NOTE: Only tighten rear bolts up firm so console is held to roof. **DO NOT** keep tightening so as to bend rear mount plate downwards. Do rear bolts up with equal tension.

Open Locker Box and remove Microphone Cable Holder and Mounting Hole Cover from inside; fasten Cover in place using screws supplied. Fasten Microphone Cable Holder in place as per radio installation instructions.

Fit Kit: RCPR96

- One (1) Front Mount Bracket
- One (1) Rear Mount Plate
- One (1) Wiring extension
- One (1) Yellow earth wire
- Two (2) 6mm x 16mm **black** round head Phillips bolts
- Two (2) 6mm x 25mm round head Phillips bolt
- One (1) Small piece of 'Blu-Tack'
- Three (3) x 100mm Sticky back foam pieces

RADIO INSTALLATION

Radio Insert Installation: for smaller size radios

PLEASE NOTE: Radio Inserts NOT INCLUDED.

Decorative side of insert faces outwards and snaps out over bottom of tray surround.

To install insert, squeeze top and bottom together; push/bend sides and squeeze into tray surround from inside to outside until bottom lip on decorative side of insert snaps/pops out over bottom of tray surround, prize with fingers to ensure bottom lip of insert is in place over tray surround as described. **Do not** scratch or mark insert or surround by prising/levering with tools; use hands/fingers only.



Radio Installation:

Place protective cover on work bench to avoid scratching console. Place console on protective cover and using a sharp knife cut a 30mm x 100mm section out of storage tray 25mm in from where rear of radio will be when installed. Use a small amount of methylated spirits on a clean cloth to clean exposed part of console and bottom rear of radio.

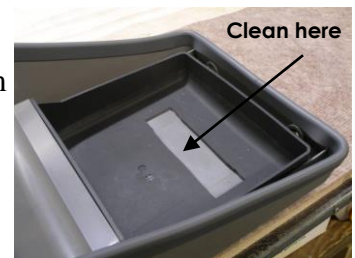

Peel one side of protective backing from foam strip supplied; apply pressure with palm of hand to adhere foam to exposed part of console. Peel backing off other side of foam strip and add one or more strips of foam to suit different size radios (see chart below). This will keep radio level with bottom of surround.

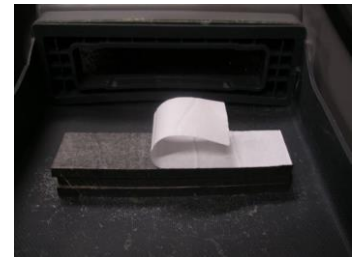

Insert radio on an angle until radio protrudes 15mm out over bottom of tray surround or insert and straighten; lay flat onto sticky back foam and apply firm pressure to top of radio with palm of hand for 30 seconds to ensure good adhesion.



Sticky back foam chart:

- One (1) strip- standard size radios
- Two (2) strips- Icom and Uniden
- Three (3) strips- GME Electrophone

Microphone and Microphone Cable Holder installation:

Install in a position that suits best, depending on vehicle and Radio model. Ensure microphone or microphone cable and holder does not foul on sun visor when pulled down.



Microphone clip on slight angle



Left hand cable outlet radios



Microphone clip on acute angle