

INSTALLATION OF ROOF CONSOLE

MAZDA BT-50/FORD RANGER PJ-PK EXTRA CAB 2006-10/11

PART NO. RCMA07EC

Failure to connect coloured wiring correctly and to tape up all connections as described in following instructions may result in an electrical short and void console warranty.

For this installation you will need a short **hand held** Phillips screwdriver, electrical insulation tape and Loctite. **Loctite all console screws when installing.** All mounting plates, brackets and hardware supplied in fit kit.

Vehicle preparation:

Remove rear view mirror, retain screws and plastic cover. Push sun visors as far as possible onto visor arm by wiggling visor back and forth and applying pressure with hands towards outside of vehicle; this will allow enough space for console to fit between visors. Swing Sun Visors around to side and lay flat to roof for ease of installation.

Switch interior light to 'off' position, prise lens cover off to expose screws, remove from roof and disconnect wiring. Put light and screws in a safe place for refit upon removal of console.

Rear Mount Plate installation:

To install Rear Mount Plate, pop upholstery button out, pull down on front of hood lining, slide plate forward then backwards over roof rib. Ensure captive nuts are to rear of vehicle and 10mm plastic spacer is placed over rear facing captive nut (Freestyle cab) and interior light plug protrudes from hole. (forward captive Nut used on Dual cab). Using a **hand held** Phillips screw driver, fasten Rear Mount Plate to the three vacant interior light screw holes using three 10# x 12mm self- tapping screws, fasten yellow earth wire to one of these screws. Push upholstery button back into place.

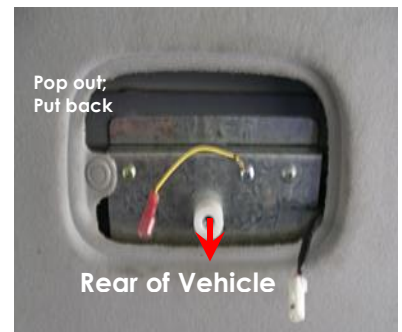

Installation preparation:

Connect wiring extension supplied to console wiring loom; connect **red** to **red**, **white** to **white** and **yellow** to **yellow**. Tape up connections **individually**.

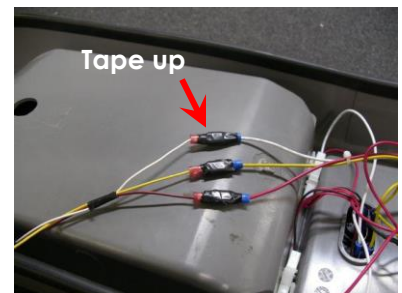

Front Mount Bracket installation:

Fasten Front Mount Bracket supplied to **inside** front of Roof Console using two (2) 6mm x 16mm **black** Phillips round head bolts supplied.



Comfortable work position:

Slide seats all way back, if right handed, sit in passenger seat; if left handed sit in driver seat.

Stand console upright on front seat and plug console wiring into interior light wiring of vehicle. Plug **white** wire on console into **red/yellow** wire of interior light plug, **red** into **blue/red** wire of interior light plug and **yellow** into **yellow** earth wire fastened to Rear Mount Plate. Check that console lights work independently once doors are shut and timer switches off then tape up to ensure wires do not become disconnected.

There is an ‘**on/off**’ switch located above radio opening. When ‘**off**’ it acts as a kill switch-- no lights will work. When ‘**on**’ lights will work independently as map/interior lights when doors are shut and timer switches off. When doors are opened lights will work as door/interior lights.



Console installation:

Hold console up in position against roof and screw up through the two (2) holes in front mount bracket into rear view mirror screw holes using original screws. Open locker box and use 6mm x 25mm round head Phillips bolt with Fastening Plate to fasten up into threaded insert in Rear Mount Plate from within the locker box. Tighten 6mm x 25mm round head bolt. *Note: only tighten rear bolt up so as Fastening Plate forms to curvature of locker box roof and console is held firm to roof lining.*

Remove rear view mirror screws from Front Mount Bracket and fasten mirror back into position. Return plastic cover.

Remove Microphone Cable Holder and Rear Cover from inside Locker Box, fasten Rear Cover in place using screws provided, Fasten Microphone Cable Holder in place as per radio installation instructions.

RCMA07EC Fit Kit:

- One (1) Front Mount Bracket
- One (1) Rear Mount Plate with 10mm spacer
- One (1) Fastening Plate
- One (1) Yellow earth wire
- One (1) Console wiring extension
- One (1) 6mm x 25mm round head Phillips bolt
- Two (2) 6mm x 16mm **black** round head Phillips bolts
- Three (3) 10# x 12mm Phillips head self tapping screws
- Three (3) x 100mm Sticky back foam pieces

RADIO INSTALLATION

Radio Insert Installation: for smaller size radios

PLEASE NOTE: Radio Inserts NOT INCLUDED.

Decorative side of insert faces outwards and snaps out over bottom of tray surround.

To install insert, squeeze top and bottom together; push/bend sides and squeeze into tray surround from inside to outside until bottom lip on decorative side of insert snaps/pops out over bottom of tray surround, prize with fingers to ensure bottom lip of insert is in place over tray surround as described. **Do not** scratch or mark insert or surround by prising/levering with tools; use hands/fingers only.



Radio Installation:

Place protective cover on work bench to avoid scratching console. Place console on protective cover and using a sharp knife cut a 30mm x 100mm section out of storage tray 25mm in from where rear of radio will be when installed. Use a small amount of methylated spirits on a clean cloth to clean exposed part of console and bottom rear of radio.



Peel one side of protective backing from foam strip supplied; apply pressure with palm of hand to adhere foam to exposed part of console. Peel backing off other side of foam strip and add one or more strips of foam to suit different size radios (see chart below). This will keep radio level with bottom of surround.



Insert radio on an angle until radio protrudes 15mm out over bottom of tray surround or insert and straighten; lay flat onto sticky back foam and apply firm pressure to top of radio with palm of hand for 30 seconds to ensure good adhesion.



Sticky back foam chart:

- One (1) strip- standard size radios
- Two (2) strips- Icom and Uniden
- Three (3) strips- GME Electrophone

Microphone and Microphone Cable Holder installation:

Install in a position that suits best, depending on vehicle and Radio model. Ensure microphone or microphone cable and holder does not foul on sun visor when pulled down.



Microphone clip on slight angle



Left hand cable outlet radios



Microphone clip on acute angle